

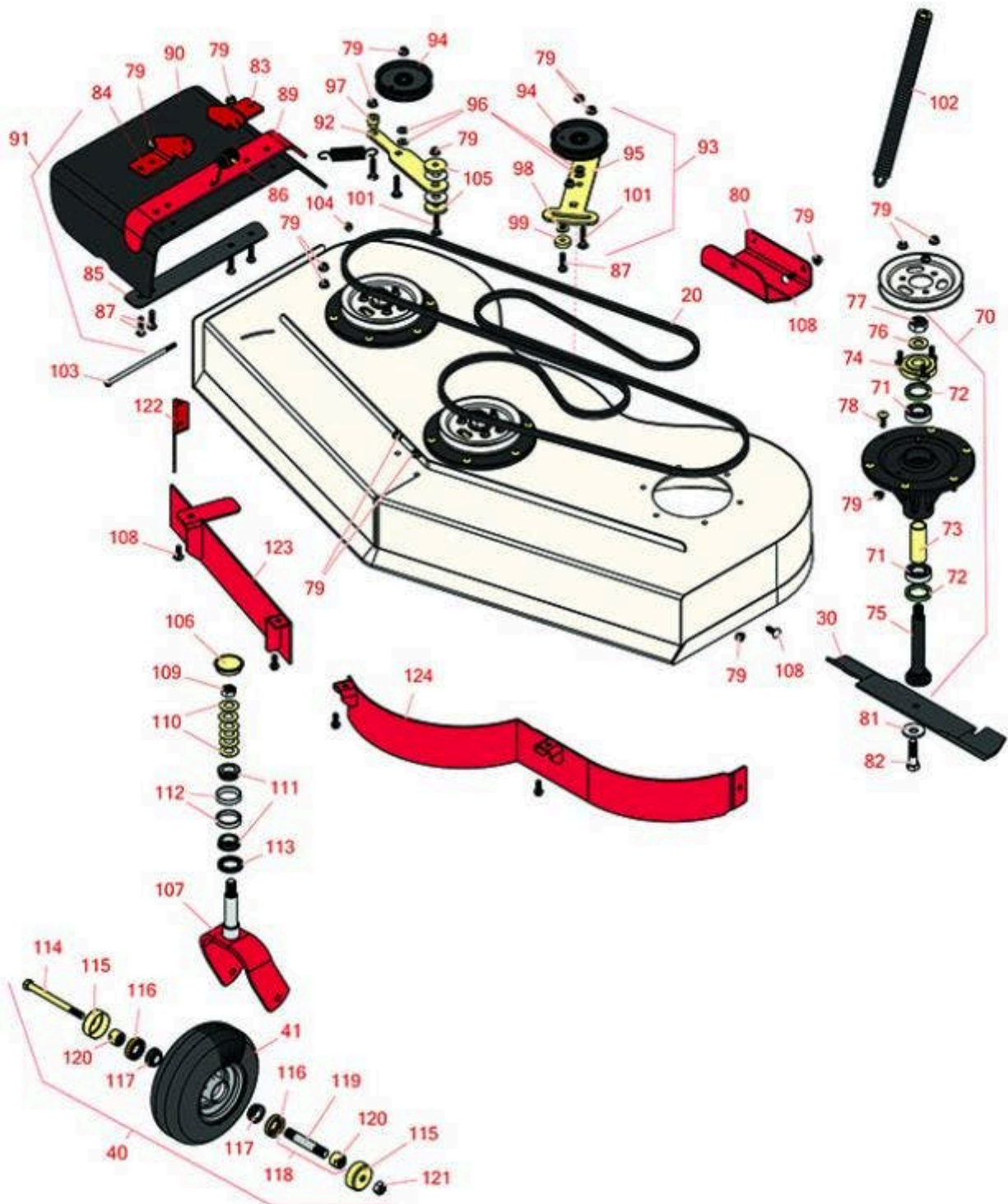

Replaces Toro GrandStand Mower Parts

Mower with 52in Deck - Models 79549

52in Deck Parts



All original equipment manufacturers names and part numbers are used for identification purposes only, and we are in no way implying that our products are original equipment parts. Prices subject to change without notice.



Replaces Toro GrandStand Mower Parts

Mower with 52in Deck - Models 79549

52in Deck Parts



| Item No | R&R Part No. | OEM Part No. | Description | Qty Req | Order Quantity |
|------------------------------|---------------------|------------------------------------|--|---------|----------------|
| Belts | | | | | |
| 20 | R114-0454 | 114-0454 | Belt - V - Deck | 1 | |
| Rotary Blades | | | | | |
| 30 | R105-7781-03 | 105-7781-03 | Mower Blade - 18 in High-Flow | 3 | |
| 30 | RRB3065-1802 | 105-7781-03, 1056-7781-03 | Mower Blade - High-Lift 18 x 2.5in x 5/8 Mt Hole | 3 | |
| 30 | R108-1117 | 108-1117 | Mower Blade Kit - 18 in High-Flow Set/6 | 1 | |
| Tires | | | | | |
| 40 | R130-4558 | 112-3810, 112-8310, 130-4558 | Wheel-Tire and Bearing Assy | 2 | |
| 41 | R130-4563 | 110-9965, 130-4563 | Wheel and Tire Assy | 2 | |
| Other Parts Available | | | | | |
| 70 | R119-8560 | 117-6157, 119-8560 | Spindle Assy | 3 | |
| 71 | R119-8558 | 119-8558, 76-7500 | Bearing - Ball - Special | 6 | |
| 72 | R253-133 | 253-133 | Seal - Oil | 6 | |
| 73 | R117-6184 | 117-6184 | Spacer | 3 | |
| 74 | R117-6172 | 117-6172 | Spindle Hub Assy w/Studs | 3 | |
| 75 | R119-8527 | 119-1851, 119-8527 | Spindle Shaft and Zerk Assy | 3 | |
| 76 | R92-5836 | 92-5836 | Flat Washer - Hardened | 3 | |
| 77 | R3296-67 | 3296-67 | Locknut - 3/4-16 Heavy Jam RH Thread | 3 | |

All original equipment manufacturers names and part numbers are used for identification purposes only, and we are in no way implying that our products are original equipment parts. Prices subject to change without notice.



Replaces Toro GrandStand Mower Parts

Mower with 52in Deck - Models 79549

52in Deck Parts



| Item No | R&R Part No. | OEM Part No. | Description | Qty Req | Order Quantity |
|---------|---------------------|---|---|---------|----------------|
| 78 | R114-8195 | 114-8195, R & R ONLY | Bolt- Ribbed Neck | 18 | |
| 79 | R104-8301 | 104-8301, 104-9301, 109-6658, 133-7570 | Locknut - 3/8-16 Nylon Flanged | 41 | |
| 80 | R114-1908-01 | 114-1908-01 | Skid | 1 | |
| 81 | R103-0865 | 103-0865 | Washer - Blade Bolt HD | 3 | |
| 82 | R51-4060 | 51-4060 | Bolt - Blade | 3 | |
| 83 | R108-4059-01 | 108-4059-01 | Plate-Hinge, Rear | 1 | |
| 84 | R106-3253-01 | 106-3253-01 | Plate-Hinge, Front | 1 | |
| 85 | R106-3248-03 | 106-3248-03 | Strap - Discharge | 1 | |
| 86 | R108-4052 | 108-4052 | Spring - Torsion | 1 | |
| 87 | R3231-4 | 01-157-0440, 01-173-0612, 3231-4 | Bolt - Carriage 3/8-16 x 1-1/2 | 6 | |
| 89 | R106-3246-01 | 106-3246-01 | Deflector | 1 | |
| 90 | R151416 | 108-5029, 110-0759, 151416 | Deflector - Long | 1 | |
| 91 | R120-2451 | 120-2451, 121-5960 | Deflector Assy | 1 | |
| 92 | R120-6409 | 120-6409 | Idler Arm | 1 | |
| 93 | R117-0446 | 117-0446 | Idler Adjust Assy | 1 | |
| 94 | R93-1622 | 93-1622 | Idler Pulley - Flat 4 in Dia with .375 Bore | 1 | |
| 95 | R114-1991 | 114-1991 | Plate- Idler | 1 | |

All original equipment manufacturers names and part numbers are used for identification purposes only, and we are in no way implying that our products are original equipment parts. Prices subject to change without notice.



Replaces Toro GrandStand Mower Parts

Mower with 52in Deck - Models 79549

52in Deck Parts



| Item No | R&R Part No. | OEM Part No. | Description | Qty Req | Order Quantity |
|---------|------------------|--|----------------------------------|---------|----------------|
| 96 | R453011 | 01-166-0100, 01-166-0120, 01-166-0270, 01-166-0500, 01-166-0600, 01-166-0620, 132-4593, 2356-3, 237-12, 24-10-AD, 24-11-AD, 24-11-BD, 24-12-AD, 24-12-BD, 30-9310, 32-8190, 3256-24, 3256-3, 3256-36, 3256-4, 453011, 47-9950, 48-9220, 513458, 7-0052 | Washer - Flat 3/8 SAE Y/Zinc | 3 | |
| 97 | R1-603496 | 1-603496 | Bushing - Idler | 1 | |
| 98 | R98-5975 | 98-5975 | Washer - Belleville | 1 | |
| 99 | R105-7788 | 105-7788 | Spacer .386" x 1 1/4" x .340" | 1 | |
| 101 | R3231-5 | 3231-5 | Bolt - Carriage 3/8-16 x 1-3/4 | 1 | |
| 102 | R116-0886 | 116-0886 | Spring - Extension | 2 | |
| 103 | R322-50 | 322-50 | Bolt - Hx HD 5/16-18 x 7 1/2 | 1 | |
| 104 | R104-8300 | 104-8300, 104-8300, 119-4041 | Locknut - 5/16-18 Flanged Y/Zinc | 1 | |
| 105 | R110-9981 | 110-9981 | Washer-Plain | 2 | |
| 106 | R103-4882 | 103-4882 | Grease Cap - Castor | 2 | |

All original equipment manufacturers names and part numbers are used for identification purposes only, and we are in no way implying that our products are original equipment parts. Prices subject to change without notice.



Replaces Toro GrandStand Mower Parts

Mower with 52in Deck - Models 79549

52in Deck Parts



| Item No | R&R Part No. | OEM Part No. | Description | Qty Req | Order Quantity |
|---------|---------------------|--|------------------------------|---------|----------------|
| 107 | R121-7988-01 | 121-7988-01 | Fork - Caster | 2 | |
| 108 | R3231-2 | 01-157-0170, 01-173-0608, 3231-2, 3231-22, 3231-28, 900063P | Bolt - Carriage 3/8-16 x 1 | 5 | |
| 109 | R3296-51 | 3296-51, 3296-81 | Nut - Nylon Lock 3/4-10 Gr 8 | 2 | |
| 110 | R1-633508 | 1-633508 | Washer - Spring Disc | 12 | |
| 111 | R254-94 | 1-543509, 254-94, 32-8090, 32-8240, 32-9640, 40440, 62-3330 | Tapered Bearing Cone | 4 | |
| 112 | R254-72 | 01-103-0050, 01-103-0120, 01-103-0140, 1-543508, 254-71, 254-72, 40439, 62-3340, 99-4511 | Cup - Bearing | 4 | |
| 113 | R116-5647 | 116-5647 | Seal - Grease | 2 | |
| 114 | R325-20 | 01-150-1250, 01-178-0848, 325-20 | Bolt - Hx HD 1/2-13 x 6 | 2 | |
| 115 | R103-2768 | 103-2768 | Guard - Seal | 4 | |
| 116 | R103-0063 | 103-0063 | Seal - Grease | 4 | |

All original equipment manufacturers names and part numbers are used for identification purposes only, and we are in no way implying that our products are original equipment parts. Prices subject to change without notice.



Replaces Toro GrandStand Mower Parts

Mower with 52in Deck - Models 79549

52in Deck Parts



| Item No | R&R Part No. | OEM Part No. | Description | Qty Req | Order Quantity |
|---------|---------------------|---|-----------------------------|---------|----------------|
| 117 | R254-78 | 01-102-0060, 01-102-0130, 1-633585, 254-78, 32-7790, 32-9580, 93-4813 | Tapered Bearing Cone | 4 | |
| 118 | R126-5359 | 126-5359 | Caster Axle Assy w/Bushing | 2 | |
| 119 | R103-3157 | 103-3157 | Axle - Caster Wheel | 2 | |
| 120 | R103-3051 | 103-3051 | Spacer - Nut - Hardened | 4 | |
| 121 | R3296-25 | 30-3380, 32127-21, 32127-31, 3290-160, 3290-33, 3296-13, 3296-25, 3296-45, 329645 | Locknut - 1/2-13 Heavy ESNA | 2 | |
| 122 | R106-3216-01 | 106-3216-01 | Baffle - Discharge | 1 | |
| 123 | R121-1790-01 | 121-1790-01 | Baffle | 1 | |
| 124 | R114-1979-01 | 114-1979-01 | Baffle - 52 Inch | 1 | |

All original equipment manufacturers names and part numbers are used for identification purposes only, and we are in no way implying that our products are original equipment parts. Prices subject to change without notice.