

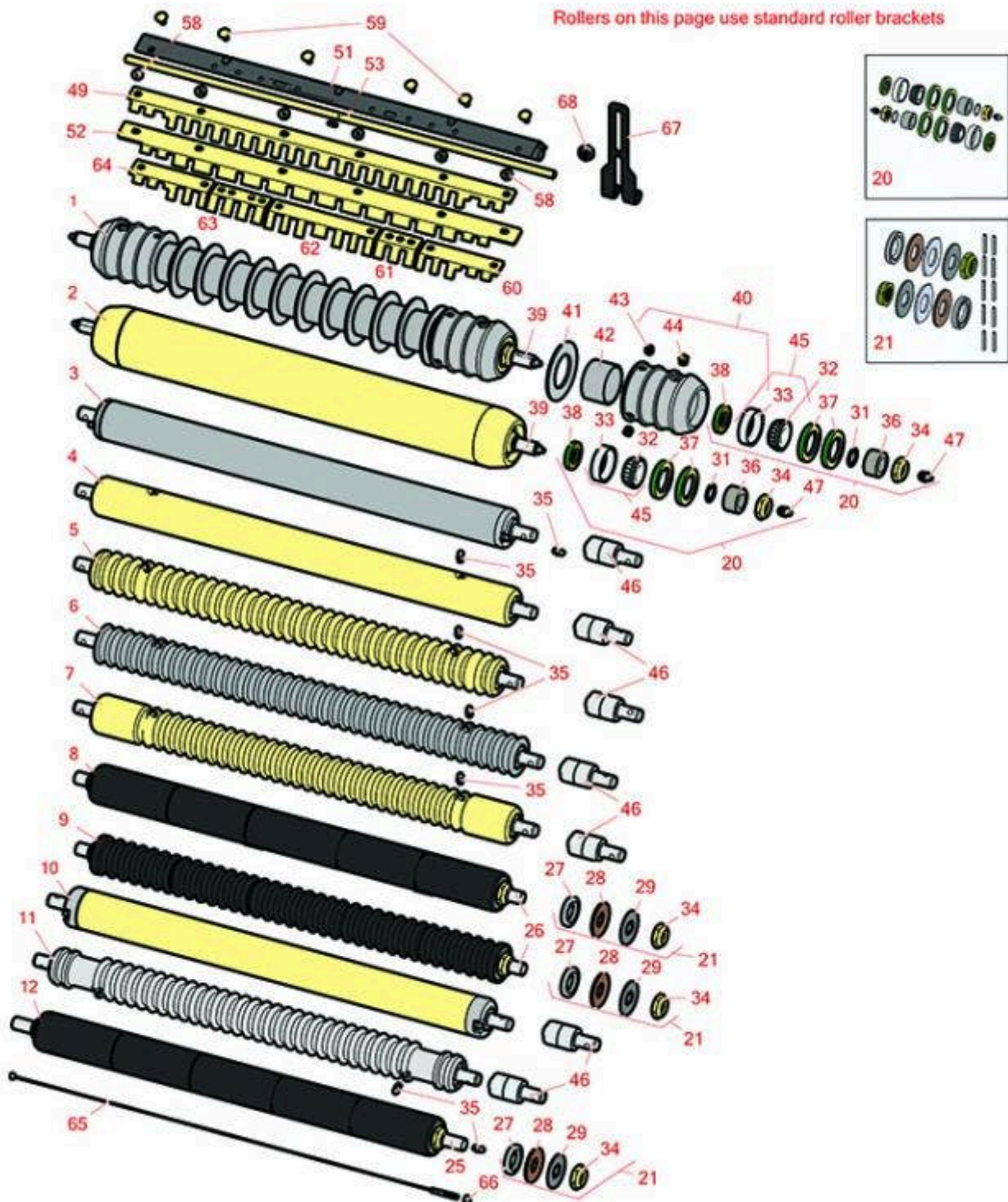

# Replaces John Deere 2750 Riding Greens Mower Parts

Cutting Unit  
Rollers



All original equipment manufacturers names and part numbers are used for identification purposes only, and we are in no way implying that our products are original equipment parts. Prices subject to change without notice.



# Replaces John Deere 2750 Riding Greens Mower Parts

Cutting Unit  
Rollers



| Item No | R&R Part No. | OEM Part No. | Description | Qty Req | Order Quantity |
|---------|--------------|--------------|-------------|---------|----------------|
|---------|--------------|--------------|-------------|---------|----------------|

## R&R Rollers Available

|   |                  |                                  |                                       |   |  |
|---|------------------|----------------------------------|---------------------------------------|---|--|
| 1   | <b>R500512</b>   | AMT2966,<br>BM25317              | Roller - Grooved Repairable Steel     | 1 |  |
| <i>Detail Description: Constructed with a through shaft and greasable ball bearings. This roller can be repaired by unscrewing the ends and replacing the series of washers and spacers.:</i> |                  |                                  |                                       |   |  |
| 2   | <b>RAET11263</b> | AET11263,<br>AMT2967             | Roller - Smooth Tubular Steel         | 1 |  |
| <i>Detail Description: Constructed with a through shaft, this heavy duty roller uses greasable tapered bearings for extended life.:</i>   |                  |                                  |                                       |   |  |
| 3   | <b>RAET10111</b> | AET10111,<br>AMT2876             | Roller - Smooth Tubular Steel         | 1 |  |
| <i>Detail Description: This tubular steel roller uses greasable "water-pump" style bearings.:</i>   |                  |                                  |                                       |   |  |
| 4   | <b>RAMT1442</b>  | AMT1442,<br>AMT2878              | Roller - Smooth Solid Steel           | 1 |  |
| <i>Detail Description: Machined from solid steel, this heavy weight roller uses greasable "water-pump" style bearings.:</i>   |                  |                                  |                                       |   |  |
| 5   | <b>RAET10954</b> | AET10954,<br>AMT2875,<br>AMT2879 | Roller - Grooved Machined Solid Steel | 1 |  |
| <i>Detail Description: Machined from solid steel, this heavy weight roller uses greasable "water-pump" style bearings.:</i>   |                  |                                  |                                       |   |  |
| 6   | <b>RAMT1061</b>  | AET10557,<br>AMT1061,<br>AMT2877 | Roller - Grooved Machined Solid Steel | 1 |  |
| <i>Detail Description: Machined from solid steel, this heavy weight roller uses greasable "water-pump" style bearings.:</i>   |                  |                                  |                                       |   |  |
| 7   | <b>RAMT1443</b>  | AMT1443,<br>AMT2879              | Roller - Grooved Machined Solid Steel | 1 |  |
| <i>Detail Description: Machined from solid steel, this heavy weight roller uses greasable "water-pump" style bearings. Extended length body.:</i>   |                  |                                  |                                       |   |  |

All original equipment manufacturers names and part numbers are used for identification purposes only, and we are in no way implying that our products are original equipment parts. Prices subject to change without notice.



# Replaces John Deere 2750 Riding Greens Mower Parts

Cutting Unit  
Rollers



| Item No  | R&R Part No. | OEM Part No. | Description                        | Qty Req | Order Quantity |
|--|--------------|--------------|------------------------------------|---------|----------------|
| 8  | R120255      |              | Roller - Smooth UHMW Polyethylene  | 1       |                |
| <i>Detail Description: Machined from solid UHMW, this low maintenance roller uses a 1" solid stainless steel shaft and requires no grease. UHMW material prevents build-up of debris.:</i>   |              |              |                                    |         |                |
| 9  | R120250      |              | Roller - Grooved UHMW Polyethylene | 1       |                |
| <i>Detail Description: Machined from solid UHMW, this low maintenance roller rotates around a 1" solid stainless steel shaft and requires no bearings or grease. Patented groove design and smooth UHMW material prevents build-up of debris.:</i> |              |              |                                    |         |                |
| 10   | RAMT1060     | AMT1060      | Roller - Smooth Tubular Steel      | 1       |                |
| <i>Detail Description: This tubular steel roller uses greasable "water-pump" style bearings.:</i>  |              |              |                                    |         |                |
| 11   | RBTC10267    | BTC10267     | Roller - Grooved Steel             | 1       |                |
| 12   | R120260      |              | Roller - Smooth UHMW Polyethylene  | 1       |                |
| <i>Detail Description: Machined from solid UHMW, this low maintenance roller uses a 1" solid stainless steel shaft and requires no grease. UHMW material prevents build-up of debris.:</i>   |              |              |                                    |         |                |
| <b>Overhaul Kit</b>  |              |              |                                    |         |                |
| 20   | RAET10632    | AET10632     | Overhaul Kit - Roller              | 1       |                |
| <i>Detail Description: Includes 4 ea: RET15755 Seal; 2 ea: R237-54 O-Ring, R253-122 Seal, R254-78 Bearing, R254-79 Cup, R3296-15 Locknut, R471219 Grease Zerk, RET15726 Sleeve, RET15756 Seal:</i>   |              |              |                                    |         |                |
| 21   | R101395      |              | Overhaul Kit - UHMW Roller         | 1       |                |
| <i>Detail Description: Fits all R&amp;R 2" Dia. Black UHMW Polyethylene Rollers. Includes 10 ea.: R150322 Roll Pins; 2 ea.: R3296-15 Locknuts, R150347T Teflon Seals, R150333 Thrust Washers, &amp; R150334A Bronze Thrust Washers:</i>            |              |              |                                    |         |                |
| <b>Other Parts Available</b>   |              |              |                                    |         |                |
| 25   | R120261      |              | Shaft - 1 SS Rear Roller           | 1       |                |
| 26   | R120251      |              | Shaft - 1 SS Front Roller          | 1       |                |

All original equipment manufacturers names and part numbers are used for identification purposes only, and we are in no way implying that our products are original equipment parts. Prices subject to change without notice.



# Replaces John Deere 2750 Riding Greens Mower Parts

Cutting Unit  
Rollers



| Item No   | R&R Part No. | OEM Part No.                 | Description                    | Qty Req | Order Quantity |
|---|--------------|------------------------------|--------------------------------|---------|----------------|
| 27  | R150347T     |                              | Seal - Nonstick Lip            | 2       |                |
| 28  | R150334A     |                              | Washer - Thrust SAE660 Bronze  | 2       |                |
| 29  | R150333      |                              | Washer - Flat Keyed Outer SS   | 2       |                |
| 31  | R237-54      | U46731,<br>U6731             | O-Ring - Small                 | 2       |                |
| 32  | R254-78      | JD8188                       | Tapered Bearing Cone           | 2       |                |
| 33  | R254-79      | JD8226                       | Cup - Bearing                  | 2       |                |
| <i>Detail Description: Use R254-79M installation mandrel to properly install race.:</i> |              |                              |                                |         |                |
| 34  | R3296-15     | N101345                      | Locknut - 3/4-16 Nylon Jam     | 2       |                |
| 35  | R302-5       | JD7797,<br>JD7842,<br>JD7844 | Fitting - Grease               | 2       |                |
| 36  | RET15726     | ET15726,<br>RET15726         | Sleeve - Wear Hardened         | 2       |                |
| 37  | RET15755     | ET15755                      | Seal - Oil                     | 4       |                |
| 38  | RET15756     | ET15756,<br>MT1739,<br>MT739 | Seal                           | 2       |                |
| 39  | RET17515     | ET17515                      | Shaft - Roller                 | 1       |                |
| 40  | R500511      |                              | Roller End - Threaded 3        | 2       |                |
| 41  | R150673      |                              | Washer - 3 Repairable Roller   | 11      |                |
| 42  | R150676      |                              | Spacer - 2-3/4 Dia x 1-1/4 L   | 10      |                |
| 43  | R150691      |                              | Screw - Set Nyloc 3/8-16 x 3/8 | 4       |                |
| 44  | R170714      | E14814                       | Fitting - Pressure Relief      | 2       |                |
| 45  | R500534      |                              | Bearing - with Cup             | 2       |                |

All original equipment manufacturers names and part numbers are used for identification purposes only, and we are in no way implying that our products are original equipment parts. Prices subject to change without notice.



# Replaces John Deere 2750 Riding Greens Mower Parts

Cutting Unit  
Rollers



| Item No   | R&R Part No.     | OEM Part No.                            | Description                       | Qty Req | Order Quantity |
|---|------------------|---|-----------------------------------|---------|----------------|
| <i>Detail Description: Kit includes: 1 ea R254-78- Bearing Cone &amp; R254-79 Bearing Cone:</i> |                  |   |                                   |         |                |
| 46  | <b>RAA35741</b>  | AA35741,<br>AET10129,<br>TCA22836       | Bearing                           | 2       |                |
| <i>Detail Description: 1/4" Side Hole:</i>  |                  |   |                                   |         |                |
| 47  | <b>R471219</b>   | 471219,<br>471231,<br>JD7759,<br>JD7798 | Zerk - Grease                     | 2       |                |
| 49  | <b>R500558</b>   |   | Scraper - Grooved Roller          | 1       |                |
| <i>Detail Description: 1 Piece Scraper fits OEM AET11262 &amp; AMT2966 Grooved Roller:</i>      |                  |   |                                   |         |                |
| 51  | <b>R500571</b>   | MT2369                                  | Bar - Scraper                     | 1       |                |
| 52  | <b>R500572</b>   |   | Scraper - Fits R500512 Only       | 1       |                |
| 53  | <b>RET17757</b>  | ET11757,<br>ET17757                     | Pin - Scraper                     | 1       |                |
| 58  | <b>R14M7303</b>  | 14M7303                                 | Nut - 6mm x 1.0 Flanged           | 5       |                |
| 59  | <b>R03M7251</b>  | 03M7251                                 | Bolt - Gr. Roller Scraper         | 5       |                |
| 60  | <b>RMT5159</b>   | MT5159                                  | Scraper - Fits J.D. LH End        | 1       |                |
| 61  | <b>RMT2342</b>   | MT2342                                  | Section - Grooved Scraper 3 Tooth | 2       |                |
| 62  | <b>RMT2340</b>   | MT2340                                  | Scraper - Fits J.D. Center        | 1       |                |
| 63  | <b>RMT2341</b>   | MT2341                                  | Section - Grooved Scraper 4 Tooth | 2       |                |
| 64  | <b>RMT5158</b>   | MT5158                                  | Scraper - Fits J.D. RH End        | 1       |                |
| 65  | <b>RTCA19566</b> | TCA19566                                | Cable - Smooth Roller Scraper     | 1       |                |
| 66  | <b>RU45916</b>   | 14M7298,<br>U45916                      | Locknut - 10-24 ESNA              | 2       |                |
| 67  | <b>RTC26998</b>  | TCU26998                                | Panel                             | 2       |                |

All original equipment manufacturers names and part numbers are used for identification purposes only, and we are in no way implying that our products are original equipment parts. Prices subject to change without notice.



# Replaces John Deere 2750 Riding Greens Mower Parts

*Cutting Unit  
Rollers*



| Item No | R&R Part No. | OEM Part No. | Description               | Qty Req | Order Quantity |
|---------|--------------|--------------|---------------------------|---------|----------------|
| 68      | R14M7517     | 14M7517      | Locknut - 10mm x 1.5 ESNA | 2       |                |

All original equipment manufacturers names and part numbers are used for identification purposes only, and we are in no way implying that our products are original equipment parts. Prices subject to change without notice.