

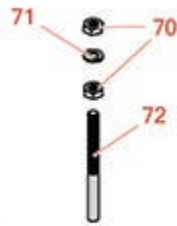

Replaces Jacobsen Trap King II Parts

Traction Unit
Traction Unit

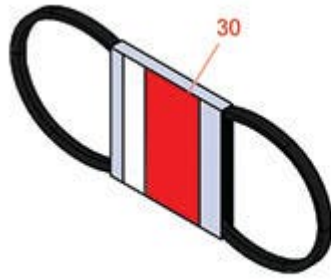

All original equipment manufacturers names and part numbers are used for identification purposes only, and we are in no way implying that our products are original equipment parts. Prices subject to change without notice.



Replaces Jacobsen Trap King II Parts

Traction Unit

Traction Unit



Item No	R&R Part No.	OEM Part No.	Description	Qty Req	Order Quantity
---------	--------------	--------------	-------------	---------	----------------

Belts

30	R337230	337230	Belt - Fits Kohler Engine	1	
----	---------	--------	---------------------------	---	--

Other Parts Available

60	R33-0990	107917	Meter - Amp	1	
----	----------	--------	-------------	---	--

70	R443110	306562, 443110, 444762	Nut - 3/8-16 Hex	70	
----	---------	------------------------------	------------------	----	--

71	R3254-6	3254-6, 446140, 446142	Washer - Lock 3/8	35	
----	---------	------------------------------	-------------------	----	--

72	R546617	546617, 837920	Stud - Rake Teeth	35	
----	---------	-------------------	-------------------	----	--

73	R19-109	546618	Rake - Finishing	5	
----	---------	--------	------------------	---	--

All original equipment manufacturers names and part numbers are used for identification purposes only, and we are in no way implying that our products are original equipment parts. Prices subject to change without notice.