



Replaces R&R Products Reel Max 331LP

Parts

Traction Unit

Front Platform & Traction Control

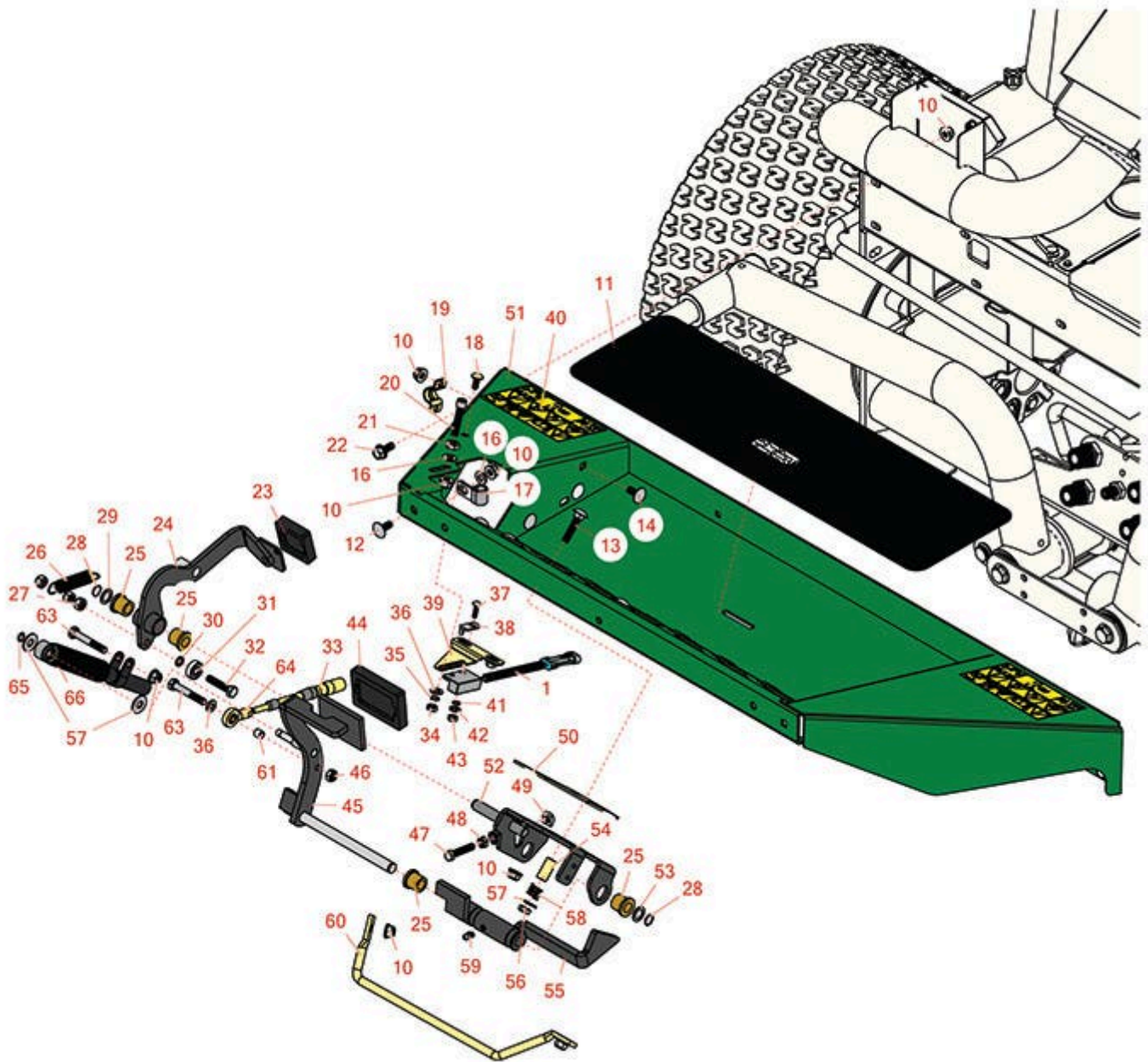

All original equipment manufacturers names and part numbers are used for identification purposes only, and we are in no way implying that our products are original equipment parts. Prices subject to change without notice.



Replaces R&R Products Reel Max 331LP

Parts

Traction Unit

Front Platform & Traction Control



Item No	R&R Part No.	OEM Part No.	Description	Qty Req	Order Quantity
Gauges and Controls					
1	R100-1270		Sensor - Proximity	1	
Other Parts Available					
10	R445722	R30-8980, R32128-2, R32128-20	Nut - Serrated Washer	22	
11	R99-3478		Pad - Anti Skid	1	
12	R3230-23	R3-5861	Bolt - 5/16-18x3/4 - Carriage	5	
13	R3230-6		Bolt - Carriage	1	
14	R112-6950	R3230-27	Bolt - Carriage 5/16-18 x 1-1/2	3	
16	R453009	3256-3, R01-166-0400, R24-10-BD, R24-9-AD, R24H1136, R32-9650, R3256-2, R3256-23, R3256-67, R3290-217, R3556-3, R4-2390, R452006, R7-0152	Washer - Flat 5/16 SAE	3	
17	R2412-103		Clamp	1	
18	R3229-1	R01-173-0406, R01-178-0408, R3229-25, R900015P	Bolt - 1/4-20 x 3/4 - Carriage	2	
19	R93-2092		Clamp - Cable	1	
20	R330748	R3274-22	Screw - 5/16-18x1 Socket HD	1	

All original equipment manufacturers names and part numbers are used for identification purposes only, and we are in no way implying that our products are original equipment parts. Prices subject to change without notice.



Replaces R&R Products Reel Max 331LP

Parts

Traction Unit

Front Platform & Traction Control



Item No	R&R Part No.	OEM Part No.	Description	Qty Req	Order Quantity
21	R443106	3218-2, 443106, R01-188-0518, R09003, R22-12-AJD, R32111-4, R3217-4, R3217-6, R513295, R513412, R915112P, R915978, R915979	Nut - 5/16-18 Y/Zinc Plated	1	
22	R3234-5	R62-3310	Bolt - 5/16-18x3/4 Hx Ser Was HD	11	
23	R74-9110		Rubber Foot Pad - Reverse	1	
24	R99-3379		Pedal - Reverse	1	
25	R256-243		Bearing - Flange	4	
26	R99-3476		Spring - Extension	1	
27	R3296-47		Locknut - 5/16-18 Jam Nyloc	3	
28	R32151-84	R32120-3, R32120-80	Ring - Shaft - Ext	2	
29	R455012	R41-8440	Washer - Flat 1/2 x 3/4	1	
30	R75-5470		Spacer - Bearing	1	
31	R251-259	R251-307	Bearing - Ball	1	
32	R322-7	R01-150-0750, R01-150-0760, R01-178-0512, R20-28-AD, R20-28-AGD, R3223-4	Bolt - Hex HD 5/16-18 x 1-1/2	1	
33	R107-2084		Traction Cable Assy	1	

All original equipment manufacturers names and part numbers are used for identification purposes only, and we are in no way implying that our products are original equipment parts. Prices subject to change without notice.



Replaces R&R Products Reel Max 331LP

Parts

Traction Unit

Front Platform & Traction Control



Item No	R&R Part No.	OEM Part No.	Description	Qty Req	Order Quantity
34	R443102	R01-188-0420, R22-11-AJD, R3217-5	Nut - 1/4-20 Yellow Zinc	2	
35	R3255-7	R76-5310	Washer - Lock 1/4 Ext Star Z	2	
36	R3256-22	R09061, R24-9-BD, R3-1032, R93-0954, R93-0989	Washer - Flat 1/4 Yellow	3	
37	R3229-20		Screw - 3/16-24 x 3/4 Carr	1	
38	R100-4872	R104-7702	Plate-Switch - Neutral	1	
39	R100-4871		Bracket - Neutral Switch	1	
40	R104-5181	R99-3560	Decal- Danger	2	
41	R3256-14	R24-7-BD, R297-3, R32125-2, R3256-51, R51-2170	Washer - 10 Flat	1	
42	R3255-17		Washer - Lock - Ext	1	
43	R3296-2	R32127-10, R9157404	Nut - #10 Lock	1	
44	R74-9100		Rubber Foot Pad - Forward	1	
45	R104-4852-03	R99-3564	Traction Pedal Assy	1	
46	R301504	R32127-24, R32146-17, R3296-16, R3296-42, R915661P, RM40333	Locknut - ESNA 1/4-20	1	
47	R322-41		Bolt - Hx HD	1	

All original equipment manufacturers names and part numbers are used for identification purposes only, and we are in no way implying that our products are original equipment parts. Prices subject to change without notice.



Replaces R&R Products Reel Max 331LP

Parts

Traction Unit

Front Platform & Traction Control



Item No	R&R Part No.	OEM Part No.	Description	Qty Req	Order Quantity
48	RP457-2	R01-191-0518, R22-12-AJK, R3218-2, R513299, RP3015-2	Nut - Jam 5/16-18 Zinc	1	
49	R99-3565		Nut - Square	1	
50	R106-2661-01		Plate - Support	1	
51	R106-4154G		Floorplate	1	
52	R95-8869-03	R95-8869	Bracket - Traction Pedal	1	
53	R73-0040		Washer - Thrust	1	
54	R95-8866		Tube- Rocker Arm	1	
55	R95-8861		Slide	1	
56	R3296-29	3296-29, R1-804256, R915662P	Locknut - 5/16-18 ESNA	1	
57	R453011	3256-24, 453011, R01-166-0100, R01-166-0120, R01-166-0270, R01-166-0500, R01-166-0600, R01-166-0620, R132-4593, R237-12, R24-10-AD, R24-11-AD, R24-11-BD, R24-12-AD, R24-12-BD, R30-9310, R32-8190, R3256-24, R3256-3, R3256-36, R3256-4, R47-9950	Washer - Flat 3/8 SAE Y/Zinc	3	

All original equipment manufacturers names and part numbers are used for identification purposes only, and we are in no way implying that our products are original equipment parts. Prices subject to change without notice.



Replaces R&R Products Reel Max 331LP Parts

*Traction Unit
Front Platform & Traction Control*



Item No	R&R Part No.	OEM Part No.	Description	Qty Req	Order Quantity
58	R65-9940		Spring	1	
59	R302-5	R173-0, R21-6010, R255825, R302-37, R302-47, R302-57, R302-58, R302-6, R31-0300, R32-9660, R471214, R471223, R471226, R60-0800, R62-3880, R92-4181, RJD7797, RJD7842, RJD7844, RM0004	Fitting - Grease	1	
60	R95-8893		Bar - Deflector	1	
61	R99-3545		Spacer	1	
63	R322-10	R20-30-AD, R24-7180, R3223-6, R513347	Bolt - Hex HD 5/16-18 x 2	2	
64	R2411-41		Rod End - Ball Joint	1	
65	R32151-3		Ring - Grip	1	
66	R76-8870	R105-7280	Lever Damper Assy	1	

All original equipment manufacturers names and part numbers are used for identification purposes only, and we are in no way implying that our products are original equipment parts. Prices subject to change without notice.