

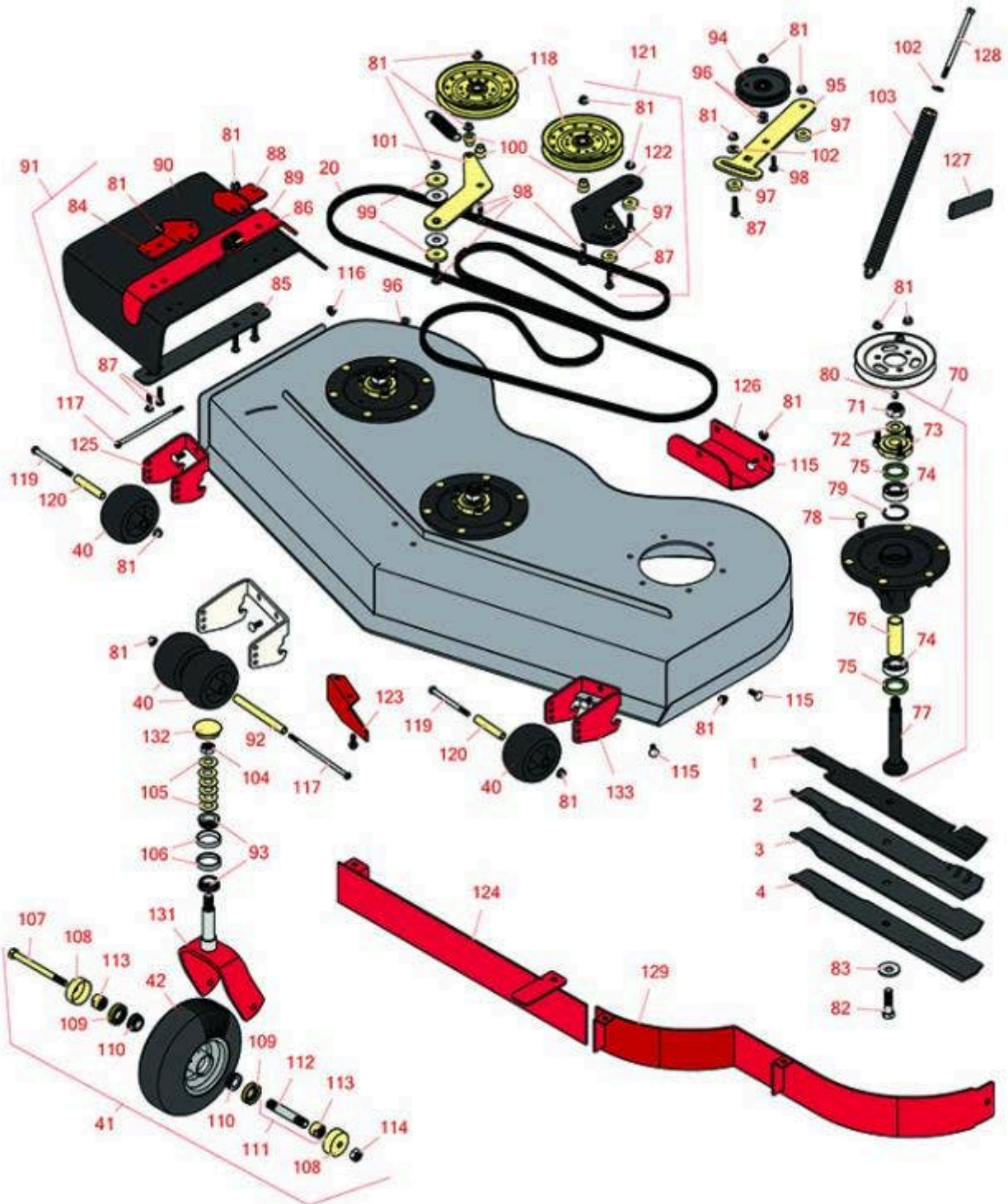

# Replaces Toro GrandStand Mower Parts

Mower with 60in Deck - Model 74576

60in Deck Parts



All original equipment manufacturers names and part numbers are used for identification purposes only, and we are in no way implying that our products are original equipment parts. Prices subject to change without notice.



# Replaces Toro GrandStand Mower Parts

Mower with 60in Deck - Model 74576

60in Deck Parts



Item No	R&R Part No.	OEM Part No.	Description	Qty Req	Order Quantity
<b>Rotary Blades</b>					
1	<b>R105-7718-03</b>	105-7718-03	Mower Blade - 20.5 in High-Flow	3	
1	<b>RRB3065-2000</b>	105-7718-03	Mower Blade - High-Lift 20.5 x 2.5in x 5/8 Mt Hole	3	
1	<b>R108-1114</b>	108-1114	Mower Blade Kit - 20.5 in High-Flow Set/6	1	
2	<b>R105-8777-03</b>	105-8777-03	Mower Blade - 20.5 in Mulcher	3	
2	<b>R108-1115</b>	108-1115	Mower Blade Kit - 20.5 in Mulcher Set/6	1	
3	<b>R105-7715-03</b>	105-1115-03, 105-7715-03	Mower Blade - 20.5 in Mid-Flow	3	
3	<b>R108-1123</b>	108-1123	Mower Blade Kit - 20.5 in Mid-Flow Set/6	1	
3	<b>R105-7777-03</b>	105-7777-03	Mower Blade - 20.5 in Recycler	3	
3	<b>R110-0405</b>	110-0405	Mower Blade Kit - 20.5 in Recycler Set/6	1	
4	<b>R105-7716-03</b>	105-7716-03	Mower Blade - 20.5 in Lo-Flow	3	
4	<b>R108-1128</b>	108-1128	Mower Blade Kit - 20.5 in Lo-Flow Set/6	1	
<b>Belts</b>					
20	<b>R106-7369</b>	106-7369	Belt - V	1	
<b>Wheels</b>					
40	<b>R68-2730</b>	1-603299, 68-2730	Wheel - Anti Scalp	4	
41	<b>R130-4558</b>	112-3810, 112-8310, 130-4558	Wheel-Tire and Bearing Assy	2	
42	<b>R130-4563</b>	110-9965, 130-4563	Wheel and Tire Assy	2	

## Other Parts Available

All original equipment manufacturers names and part numbers are used for identification purposes only, and we are in no way implying that our products are original equipment parts. Prices subject to change without notice.



# Replaces Toro GrandStand Mower Parts

Mower with 60in Deck - Model 74576

60in Deck Parts



Item No	R&R Part No.	OEM Part No.	Description	Qty Req	Order Quantity
70	<b>R119-8560</b>	117-6157, 119-8560	Spindle Assy	3	
71	<b>R3296-67</b>	3296-67	Locknut - 3/4-16 Heavy Jam RH Thread	3	
72	<b>R92-5836</b>	92-5836	Flat Washer - Hardened	3	
73	<b>R117-6172</b>	117-6172	Spindle Hub Assy w/Studs	3	
74	<b>R119-8558</b>	119-8558, 76-7500	Bearing - Ball - Special	6	
75	<b>R253-133</b>	253-133	Seal - Oil	6	
76	<b>R117-6184</b>	117-6184	Spacer	3	
77	<b>R119-8527</b>	119-1851, 119-8527	Spindle Shaft and Zerk Assy	3	
78	<b>R114-8195</b>	114-8195, R & R ONLY	Bolt- Ribbed Neck	18	
79	<b>R119-8532</b>	114-8161, 119-8532	Snap Ring	3	
80	<b>R471219</b>	30-8360, 302-2, 302-24, 302-31, 302-52, 471219	Zerk - Grease	3	
81	<b>R104-8301</b>	104-8301, 104-9301, 109-6658, 133-7570	Locknut - 3/8-16 Nylon Flanged	56	
82	<b>R51-4060</b>	51-4060	Bolt - Blade	3	
83	<b>R103-0865</b>	103-0865	Washer - Blade Bolt HD	3	
84	<b>R106-3253-01</b>	106-3253-01	Plate-Hinge, Front	1	
85	<b>R106-3248-03</b>	106-3248-03	Strap - Discharge	1	

All original equipment manufacturers names and part numbers are used for identification purposes only, and we are in no way implying that our products are original equipment parts. Prices subject to change without notice.



# Replaces Toro GrandStand Mower Parts

Mower with 60in Deck - Model 74576

60in Deck Parts



Item No	R&R Part No.	OEM Part No.	Description	Qty Req	Order Quantity
86	<b>R108-4052</b>	108-4052	Spring - Torsion	1	
87	<b>R3231-4</b>	01-157-0440, 01-173-0612, 3231-4	Bolt - Carriage 3/8-16 x 1-1/2	4	
88	<b>R108-4059-01</b>	108-4059-01	Plate-Hinge, Rear	1	
89	<b>R106-3246-01</b>	106-3246-01	Deflector	1	
90	<b>R151416</b>	108-5029, 110-0759, 151416	Deflector - Long	1	
91	<b>R120-2451</b>	120-2451, 121-5960	Deflector Assy	1	
92	<b>R98-5967</b>	98-5967	Spacer-Wheel	1	
93	<b>R254-94</b>	1-543509, 254-94, 32-8090, 32-8240, 32-9640, 40440, 62-3330	Tapered Bearing Cone	4	
94	<b>R93-1622</b>	93-1622	Idler Pulley - Flat 4 in Dia with .375 Bore	1	
95	<b>R114-1991</b>	114-1991	Plate- Idler	1	

All original equipment manufacturers names and part numbers are used for identification purposes only, and we are in no way implying that our products are original equipment parts. Prices subject to change without notice.



# Replaces Toro GrandStand Mower Parts

Mower with 60in Deck - Model 74576

60in Deck Parts



Item No	R&R Part No.	OEM Part No.	Description	Qty Req	Order Quantity
96	<b>R453011</b>	01-166-0100, 01-166-0120, 01-166-0270, 01-166-0500, 01-166-0600, 01-166-0620, 132-4593, 2356-3, 237-12, 24-10-AD, 24-11-AD, 24-11-BD, 24-12-AD, 24-12-BD, 30-9310, 32-8190, 3256-24, 3256-3, 3256-36, 3256-4, 453011, 47-9950, 48-9220, 513458, 7-0052	Washer - Flat 3/8 SAE Y/Zinc	3	
97	<b>R105-7788</b>	105-7788	Spacer .386" x 1 1/4" x .340"	2	
98	<b>R3231-5</b>	3231-5	Bolt - Carriage 3/8-16 x 1-3/4	4	
99	<b>R110-9981</b>	110-9981	Washer-Plain	2	
100	<b>R1-603496</b>	1-603496	Bushing - Idler	3	
101	<b>R121-5971</b>	121-5971	Arm-Idler, RH	1	
102	<b>R98-5975</b>	98-5975	Washer - Belleville	2	
103	<b>R116-0886</b>	116-0886	Spring - Extension	2	
104	<b>R3296-51</b>	3296-51, 3296-81	Nut - Nylon Lock 3/4-10 Gr 8	2	
105	<b>R1-633508</b>	1-633508	Washer - Spring Disc	12	

All original equipment manufacturers names and part numbers are used for identification purposes only, and we are in no way implying that our products are original equipment parts. Prices subject to change without notice.



# Replaces Toro GrandStand Mower Parts

Mower with 60in Deck - Model 74576

60in Deck Parts



Item No	R&R Part No.	OEM Part No.	Description	Qty Req	Order Quantity
106	<b>R254-72</b>	01-103-0050, 01-103-0120, 01-103-0140, 1-543508, 254-71, 254-72, 40439, 62-3340, 99-4511	Cup - Bearing	4	
107	<b>R325-20</b>	01-150-1250, 01-178-0848, 325-20	Bolt - Hx HD 1/2-13 x 6	2	
108	<b>R103-2768</b>	103-2768	Guard - Seal	4	
109	<b>R103-0063</b>	103-0063	Seal - Grease	4	
110	<b>R254-78</b>	01-102-0060, 01-102-0130, 1-633585, 254-78, 32-7790, 32-9580, 93-4813	Tapered Bearing Cone	4	
111	<b>R126-5359</b>	126-5359	Caster Axle Assy w/Bushing	2	
112	<b>R103-3157</b>	103-3157	Axle - Caster Wheel	2	
113	<b>R103-3051</b>	103-3051	Spacer - Nut - Hardened	4	
114	<b>R3296-25</b>	30-3380, 32127-21, 32127-31, 3290-160, 3290-33, 3296-13, 3296-25, 3296-45, 329645	Locknut - 1/2-13 Heavy ESNA	2	

All original equipment manufacturers names and part numbers are used for identification purposes only, and we are in no way implying that our products are original equipment parts. Prices subject to change without notice.



# Replaces Toro GrandStand Mower Parts

Mower with 60in Deck - Model 74576

60in Deck Parts



Item No	R&R Part No.	OEM Part No.	Description	Qty Req	Order Quantity
115	<b>R3231-2</b>	01-157-0170, 01-173-0608, 3231-2, 3231-22, 3231-28, 900063P	Bolt - Carriage 3/8-16 x 1	9	
116	<b>R104-8300</b>	104-8300, 104-8300 , 119-4041	Locknut - 5/16-18 Flanged Y/Zinc	2	
117	<b>R322-50</b>	322-50	Bolt - Hx HD 5/16-18 x 7 1/2	2	
118	<b>R116-4667</b>	116-4667, 126-7685	Idler -Pulley - Flat	2	
119	<b>R323-23</b>	01-150-0810, 01-178-0636, 20-60-AGD, 323-23	Bolt - Hex HD 3/8-16 x 4-1/2	2	
120	<b>R98-7912</b>	98-7912	Bushing - Spanner Wheel	2	
121	<b>R121-5965</b>	121-5965	LH Idler Arm Asm	1	
122	<b>R121-5966-03</b>	121-5966-03	Idler Arm - LH	1	
123	<b>R106-3216-01</b>	106-3216-01	Baffle - Discharge	1	
124	<b>R121-1788-01</b>	121-1788-01	Baffle Assy	1	
125	<b>R114-5213-01</b>	114-5213-01	Bracket - Wheel - RH	1	
126	<b>R114-1908-01</b>	114-1908-01	Skid	1	
127	<b>R1-633268</b>	1-633268	Grip - Lever - Foam	1	
128	<b>R323-58</b>	100-8528, 323-36, 323-58	Bolt - Hex HD	2	
129	<b>R117-9701-01</b>	117-9701-01	Baffle Assy	1	
131	<b>R121-7988-01</b>	121-7988-01	Fork - Caster	2	

All original equipment manufacturers names and part numbers are used for identification purposes only, and we are in no way implying that our products are original equipment parts. Prices subject to change without notice.



# Replaces Toro GrandStand Mower Parts

Mower with 60in Deck - Model 74576

60in Deck Parts



Item No	R&R Part No.	OEM Part No.	Description	Qty Req	Order Quantity
132	<b>R103-4882</b>	103-4882	Grease Cap - Castor	2	
133	<b>R114-5204-01</b>	114-5204-01	Bracket-Wheel - LH	1	

All original equipment manufacturers names and part numbers are used for identification purposes only, and we are in no way implying that our products are original equipment parts. Prices subject to change without notice.