



Replaces Toro Groundsmaster 4000-D

Parts

Rotary Mower - Model 30410

Lift Arm Hydraulics

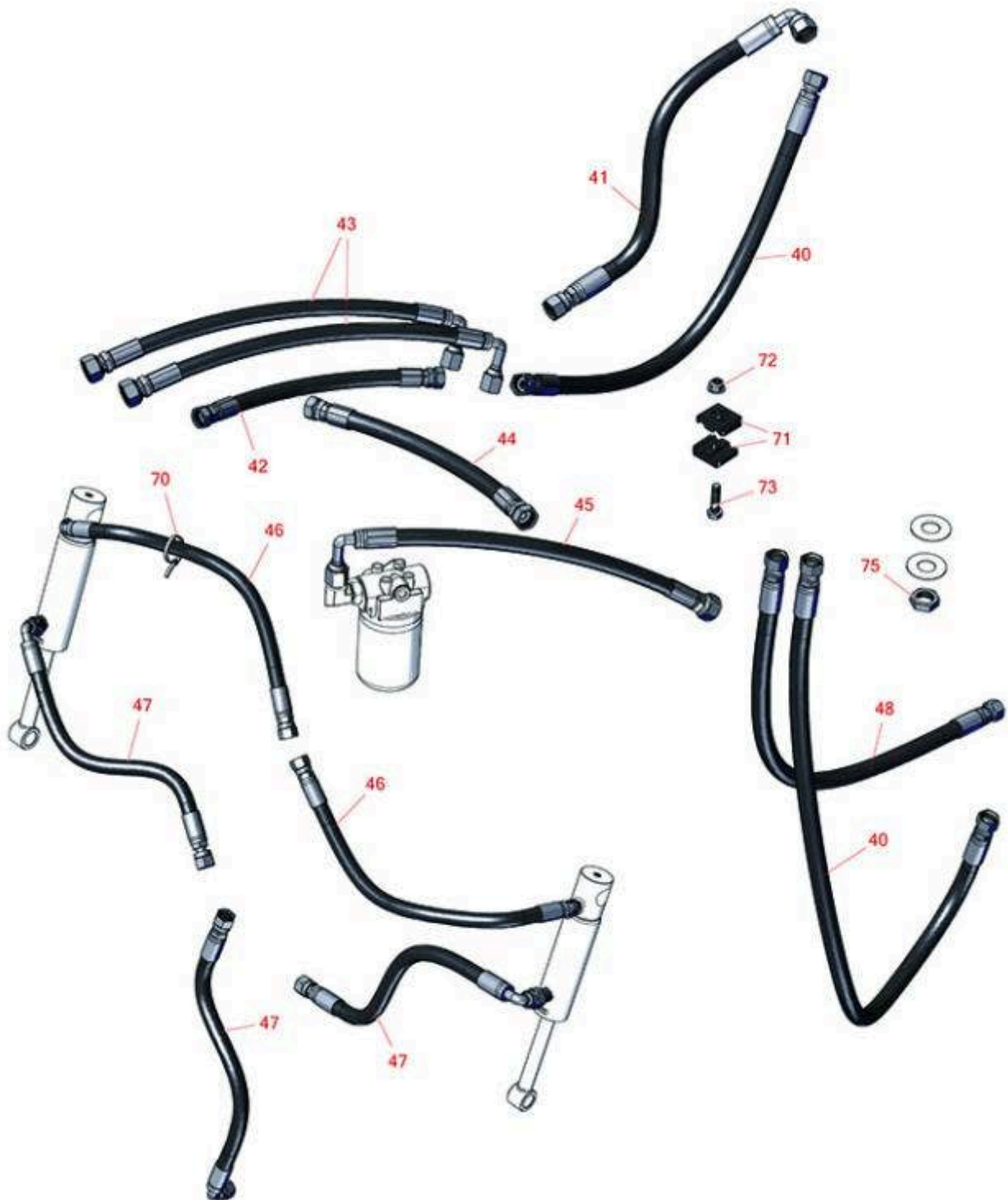

All original equipment manufacturers names and part numbers are used for identification purposes only, and we are in no way implying that our products are original equipment parts. Prices subject to change without notice.



Replaces Toro Groundsmaster 4000-D Parts

*Rotary Mower - Model 30410
Lift Arm Hydraulics*



| Item No | R&R Part No. | OEM Part No. | Description | Qty Req | Order Quantity |
|---------|------------------|--|-----------------------------------|---------|----------------|
| 40 | R100-5630 | 100-5630 | Hydraulic Hose Assy | 2 | |
| 41 | R100-5631 | 100-5631 | Hydraulic Hose Assy | 1 | |
| 42 | R100-5589 | 100-5589 | Hydraulic Hose Assy | 1 | |
| 43 | R104-2240 | 104-2240 | Hydraulic Hose Assy | 2 | |
| 44 | R104-2239 | 104-2239 | Hydraulic Hose Assy | 1 | |
| 45 | R83-9600 | 83-9600 | Hydraulic Hose Assy | 1 | |
| 46 | R92-7595 | 92-7595 | Hydraulic Hose Assy | 2 | |
| 47 | R104-2234 | 104-2234 | Hydraulic Hose Assy | 3 | |
| 48 | R100-5629 | 100-5629 | Hydraulic Hose Assy | 1 | |
| 70 | R3290-378 | 30-1740, 3290-378, 52-6570, 60-4340 | Cable Tie | 5 | |
| 71 | R56-7973 | 56-7973 | Clamp - Tube | 4 | |
| 72 | R104-8300 | 104-8300, 104-8300 , 119-4041 | Locknut - 5/16-18 Flanged Y/Zinc | 2 | |
| 73 | R400190 | 01-150-0720, 01-178-0510, 30-8680, 322-6, 513343 | Bolt - Hex HD 5/16-18 x 1-1/4 GR5 | 2 | |
| 75 | R340-70 | 340-70 | Nut - Lock | 2 | |

All original equipment manufacturers names and part numbers are used for identification purposes only, and we are in no way implying that our products are original equipment parts. Prices subject to change without notice.