

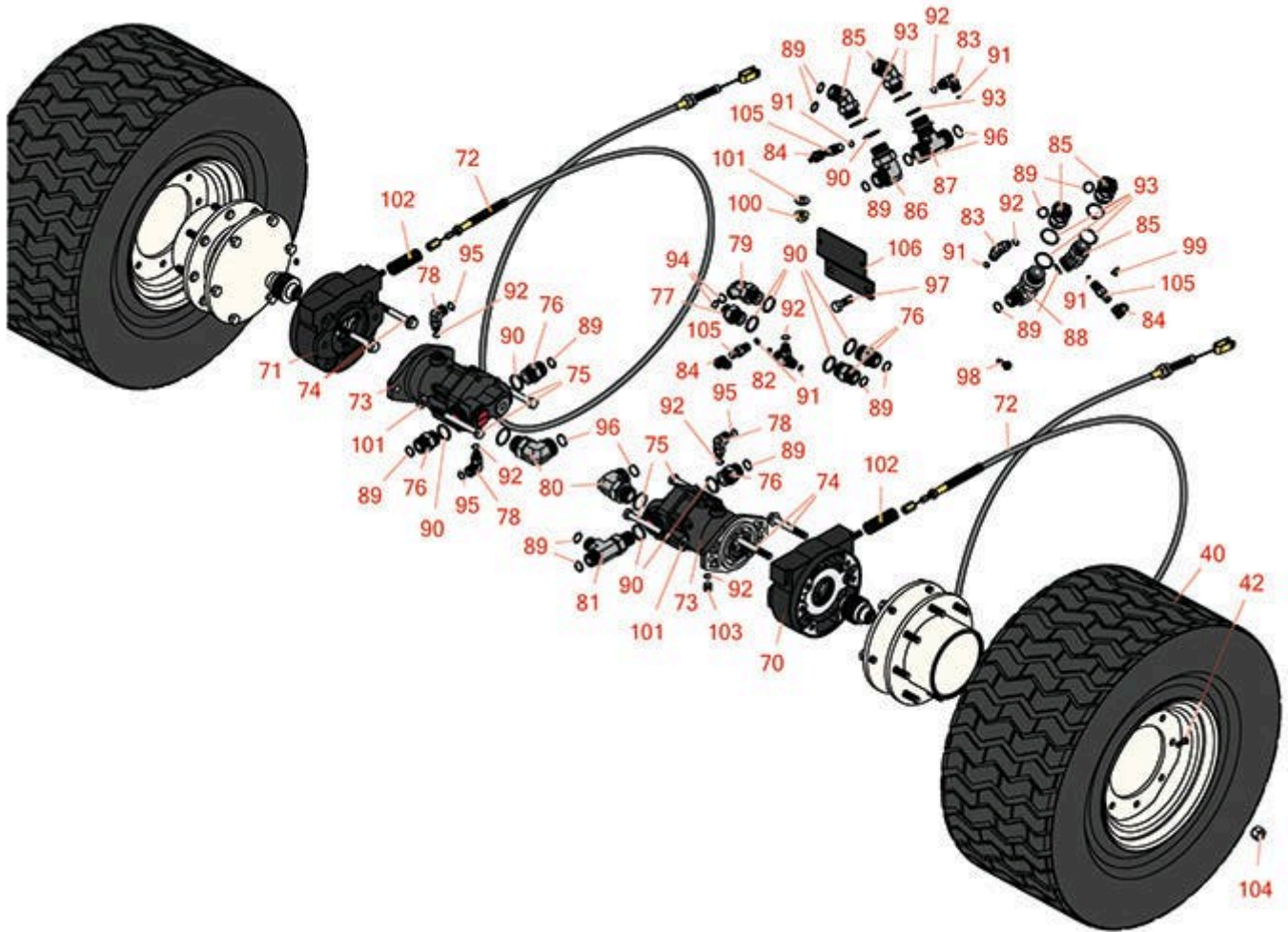

Replaces Toro Groundsmaster 4100-D

Parts

Rotary Mower - Model 30411
Front Wheels



All original equipment manufacturers names and part numbers are used for identification purposes only, and we are in no way implying that our products are original equipment parts. Prices subject to change without notice.



Replaces Toro Groundsmaster 4100-D Parts

Rotary Mower - Model 30411
Front Wheels



Item No	R&R Part No.	OEM Part No.	Description	Qty Req	Order Quantity
Tires & Wheels					
40	RCT574377	119-8313, 126-8033, 99-5434	Tire - 26x12.00-12 Nhs (6 Ply) Carlisle Multi Trac C/S	2	
42	R232-27	232-27, 232-31	Stem - Valve w/ Cap	2	
Other Parts Available					
70	R100-3070-03	100-3070-03	Brake Assy - LH	1	
71	R100-3069-03	100-3069-03	Brake Assy - RH	1	
72	R99-5501	99-5501	Brake Cable Assy	2	
73	R105-7376	105-7376	Front Piston Motor	3	
74	R33106-090	33106-090	Bolt - M12-1.75 x 90 Fl Hex HD Gr 8.8	4	
75	R33116-120	33116-120	Bolt - M12-1.75 x 120mm Hx HD	4	
76	R340-9	340-9	Fitting - Straight Connector	5	
77	R340-8	340-8	Adapter	1	
78	R340-99	340-99	Hydraulic Fitting - 90 Deg	3	
79	R340-156	340-156	Hydraulic Fitting	1	
80	R340-129	340-129	Hydraulic Fitting - 90 Deg	2	
81	R340-148	340-148	Fitting-Tee	1	
82	R340-94	340-94	Adapter	1	
83	R340-77	340-100, 340-77, 95-7889	Hydraulic Fitting	3	
84	R354-79	354-79	Cap-Dust	3	

All original equipment manufacturers names and part numbers are used for identification purposes only, and we are in no way implying that our products are original equipment parts. Prices subject to change without notice.



Replaces Toro Groundsmaster 4100-D Parts

Rotary Mower - Model 30411
Front Wheels



Item No	R&R Part No.	OEM Part No.	Description	Qty Req	Order Quantity
85	R100-5530	100-5530, 98-0657	Hydraulic Fitting - 45 Deg	5	
86	R340-142	340-142, 95-1692	Hydraulic Fitting - 90 Deg	1	
87	R104-7501	104-7501	Hydraulic Fitting	1	
88	R340-15	340-15	Hydraulic Fitting - 90 Deg	2	
89	R237-58	237-58	O-Ring	14	
90	R237-81	237-81, 237.81, 327-81	O-Ring	8	
91	R237-22	107-8844, 237-22, 237-78	O-Ring	7	
92	R237-42	237-42, 31-4160	O-Ring	7	
93	R237-146	237-146, 340-146	O-Ring	10	
94	R237-65	237-65, 237.65	O-Ring	6	
95	R237-30	23-6320, 237-30	O-Ring - Seal	3	
96	R340-65	340-65	O-Ring	4	
97	R400408	01-150-0090, 01-178-0812, 20-87-AD, 20-87-AGD, 20-87-AGF, 3226-2, 325-6, 513376, 513378	Bolt - Hex HD 1/2-13 x 1-1/2	6	

All original equipment manufacturers names and part numbers are used for identification purposes only, and we are in no way implying that our products are original equipment parts. Prices subject to change without notice.



Replaces Toro Groundsmaster 4100-D Parts

Rotary Mower - Model 30411
Front Wheels



Item No	R&R Part No.	OEM Part No.	Description	Qty Req	Order Quantity
98	R32144-11	32104-23, 32104-31, 32104-83, 32140-69, 32140-82, 32144-11	Bolt - 5/16-18 x 1 Hx Fl Tf	2	
99	R104-8300	104-8300, 104-8300 , 119-4041	Locknut - 5/16-18 Flanged Y/Zinc	7	
100	R32128-23	32128-23, 3218-23, 99-5107	Nut - Lock Hex Flanged 1/2-13	8	
101	R3256-26	01-166-0540, 01-166-0820, 17-2530, 24-13-BD, 30-8570, 3256-26, 356206, 48-9390	Washer - 1/2 in	10	
102	R94-3088	94-3088	Spring - Compression	2	
103	R353-989	353-989	Plug - Hex - Hollow	2	
104	R242-50	242-50	Nut - 1/2-20 Wheel	16	
105	R354-77	354-77	Fitting-Quick	3	
106	R104-0746-03	104-0746-03	Bracket - Manifold	1	

All original equipment manufacturers names and part numbers are used for identification purposes only, and we are in no way implying that our products are original equipment parts. Prices subject to change without notice.